

FANTAZIE GRANDE

Č. F308-DC

1880x2080x1200/500
dub-cink

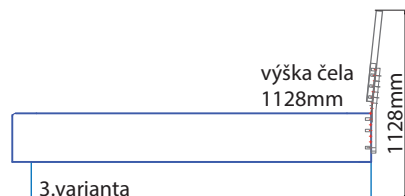
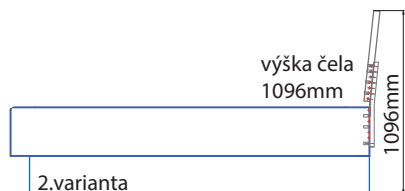
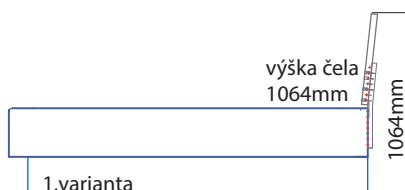
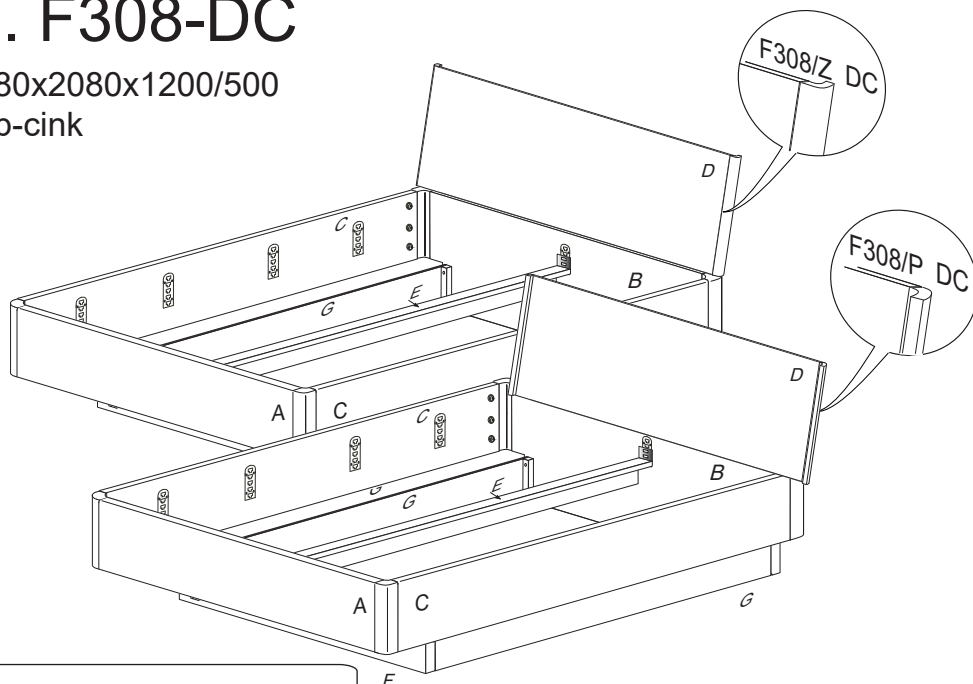

Kolíky vždy narazte nejprve do otvorů ve hranách dílců, je nutné je zarazit se stejným přesahem. V případě, že některý kolík přesahuje, je nutné jej zakrátit. Dílce srážejte kladivem pouze přes dřevěnou podložku.

V případě vrzání vtačte do spoje tekuté mýdlo v poměru 1:1 s vodou. Tento jev se u nábytku z masivu vyskytuje běžně.

Olejová úprava výrobku vykazuje po určité době specifickou vůni, která není zdravotně závadná a časem vyprchá.

| | | | | | | |
|-----------|-----------|------------|------------|----------------|------------|------------|
| | 4 x1 | 5 x1 | 8 x8 | 9 x22 | 29 x1 | 43 x36 |
| | č.4 | č.5 | 8x35mm | 10x50mm | 4x60mm | 6x50mm |
| 44 x6 | 45 x6 | 46 x16 | 47 x16 | 90 x2 | 92 x50 | 117 x8 |
| 6x90mm | 13520 | 6x90mm | 13501 | H-lišta 1540mm | 1,4x20mm | varifix |
| | | | | | | filc |

1/5

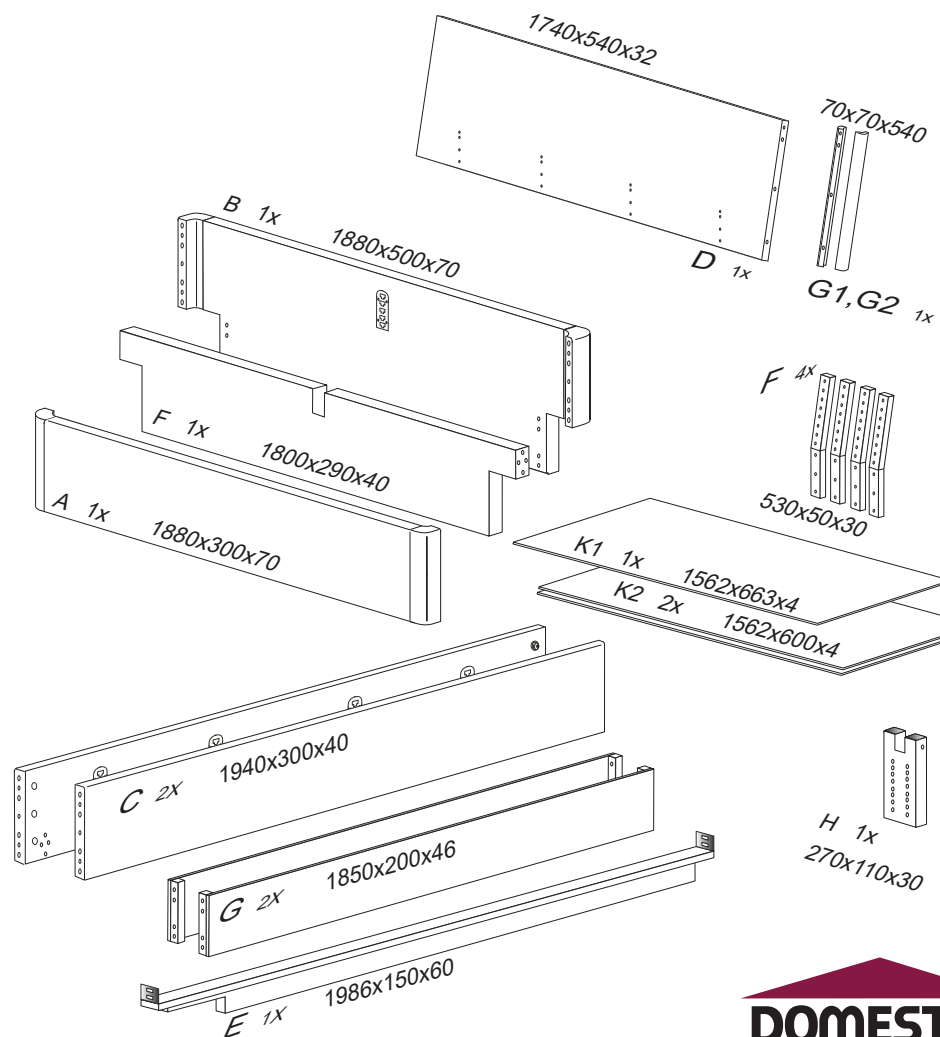

F308-DC

1

2

3

4

2/5

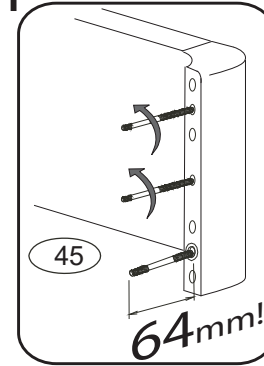
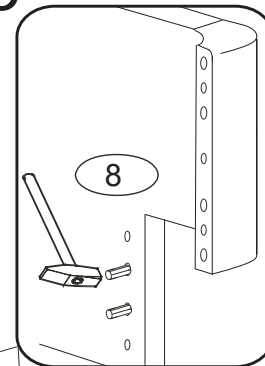
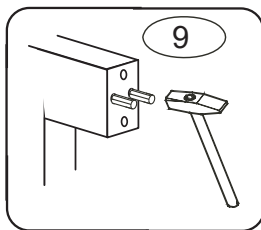
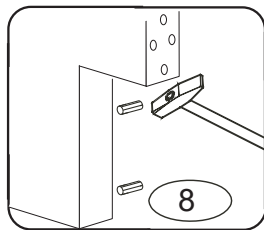

pro snazší zašroubování
namažte šroub mýdlem
nebo olejem

5

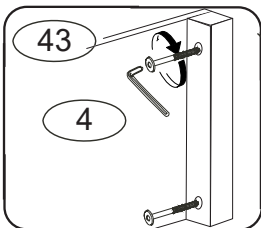

7

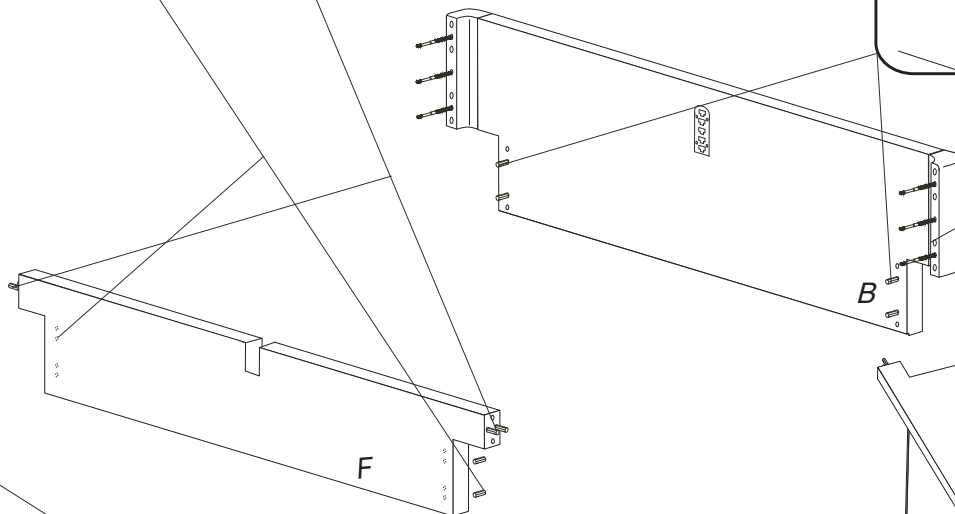
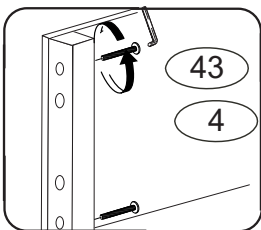

8

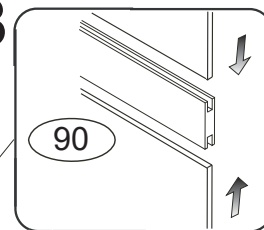

10

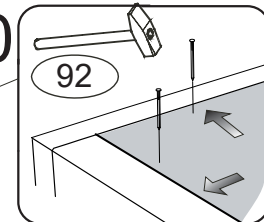

11

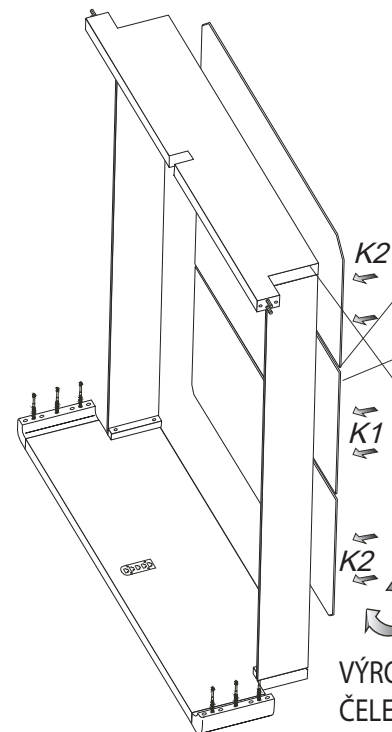
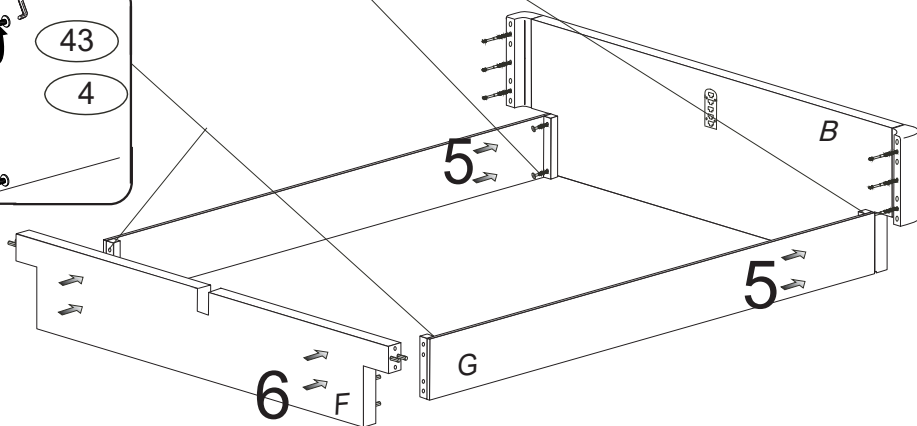
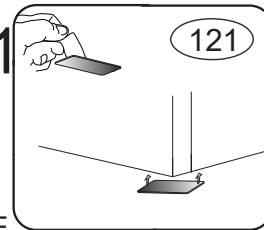

VÝROBEK POLOŽTE
ČELEM DOLŮ

doprostřed rohu
rámu vlepte filc č.121

12

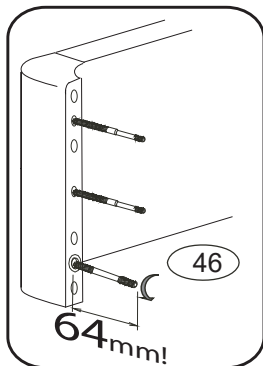

13

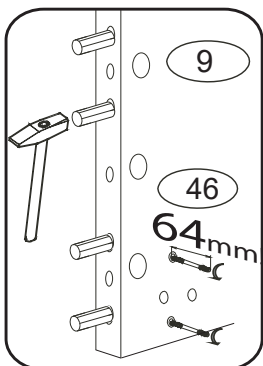

pro snazší zašroubování
namažte šroub mýdlem
nebo olejem

17A

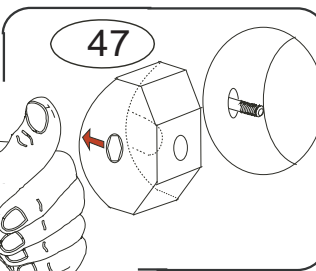

17B

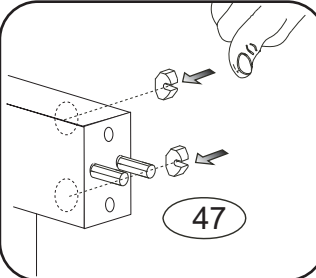

18

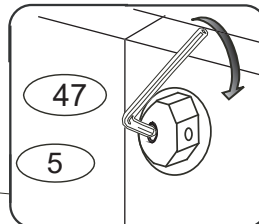

NEDOTAHUJTE-
pouze lehce zachyťte závit
z důvodu montáže dílu „E“

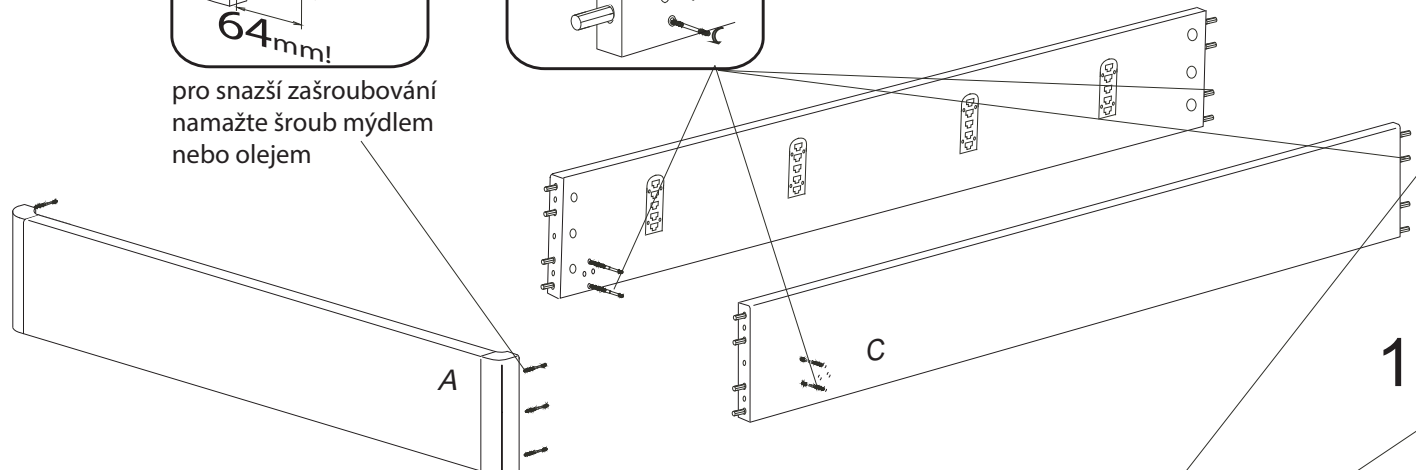

15

14

14

15

14

Díly C nasazujte
do dílu B zešikma=
mírně rozevřené

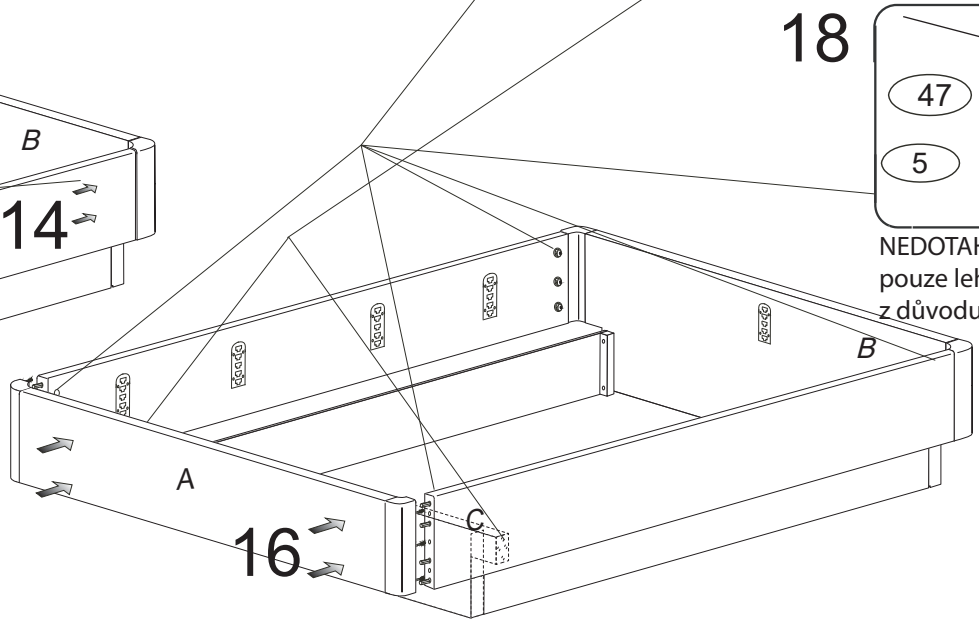

16

F308-DC

4/5

19

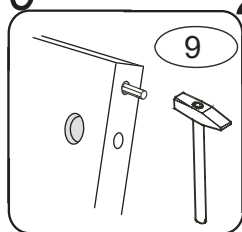

20

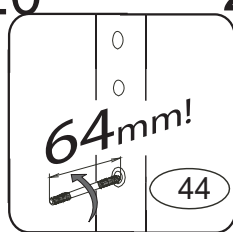

21

Nasadte zaoblené boky na čelo do zvolené polohy (směrem dopředu či dozadu)

23

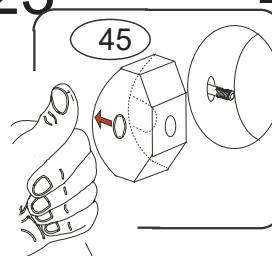

24

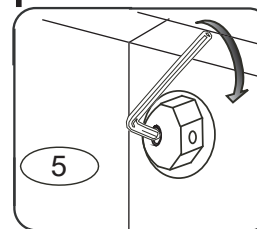

pro snazší zašroubování namažte šroub mýdlem nebo olejem

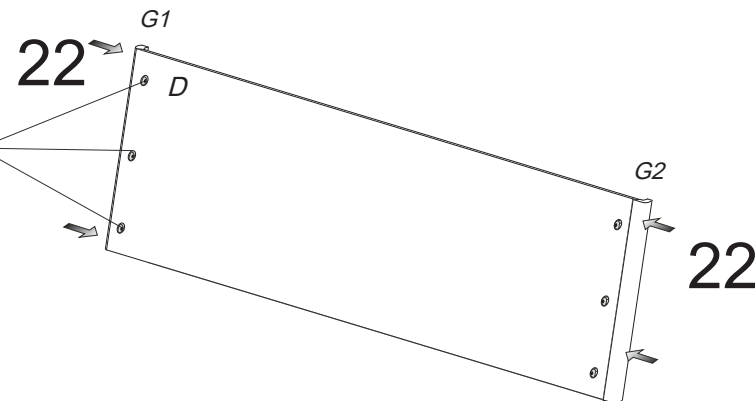

26

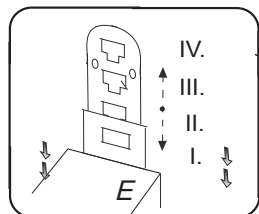

Nasadte střednici E do vybrané polohy.

27

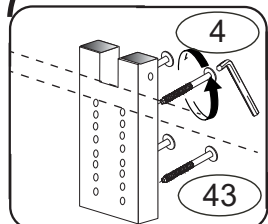

Nastavte polohu dílu H podle výšky matrace.

28

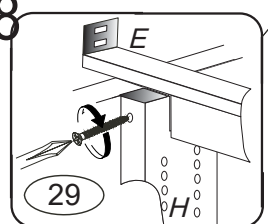

27

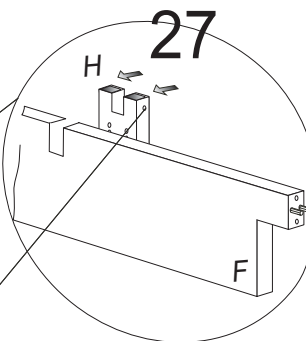

25

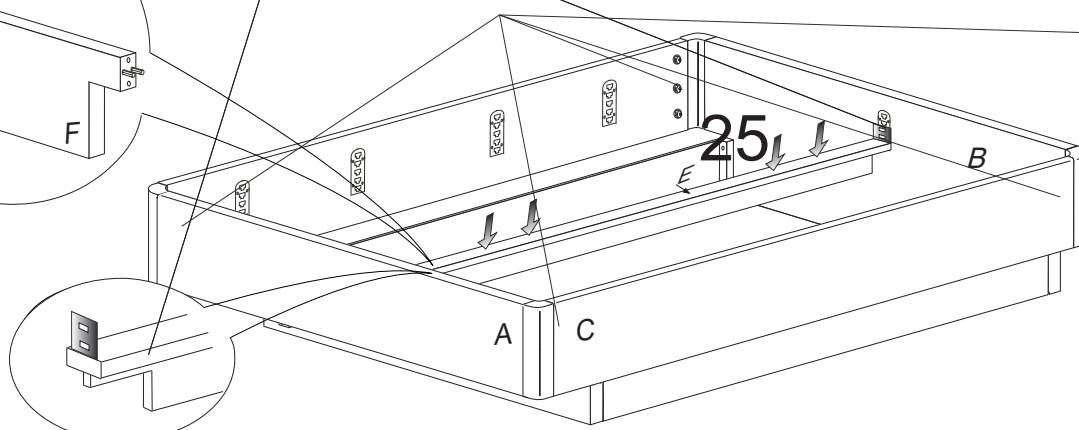

29

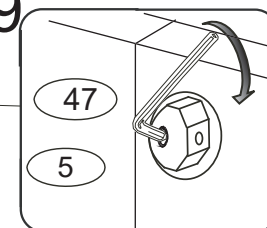

Dotáhněte pevně.

30

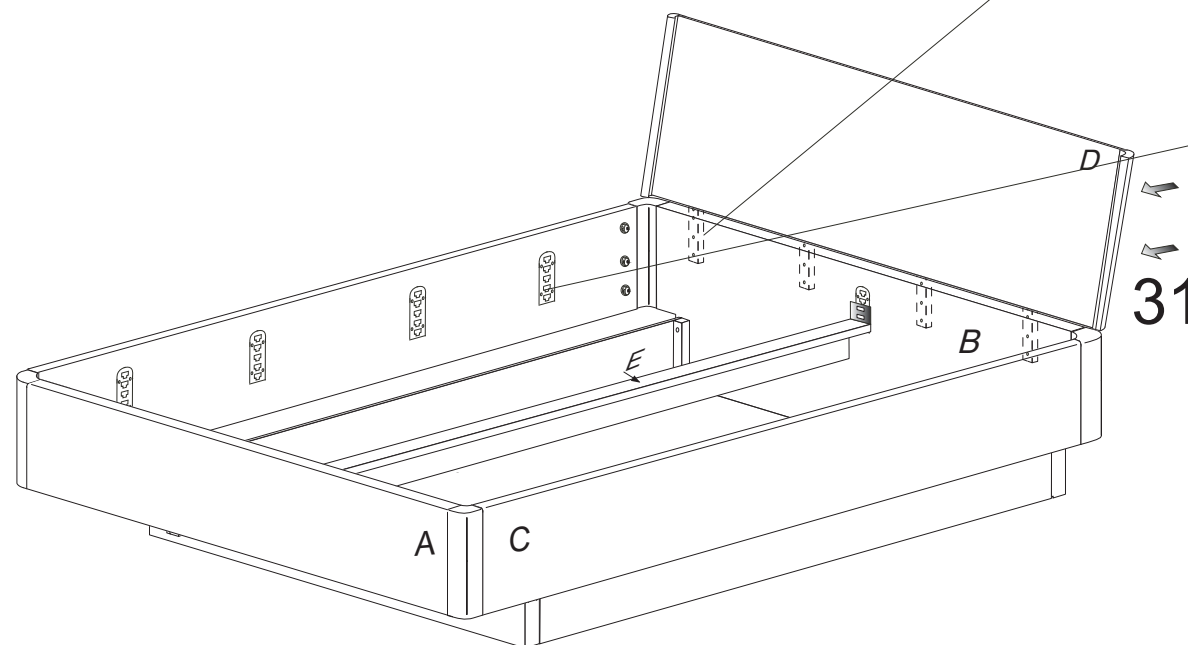
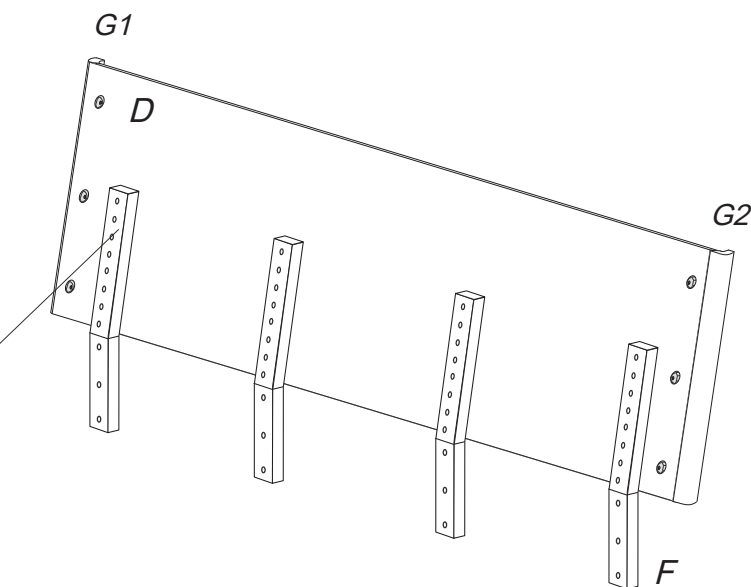
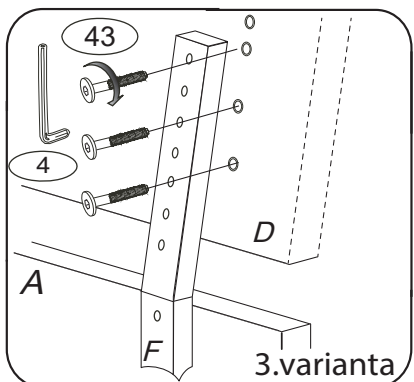
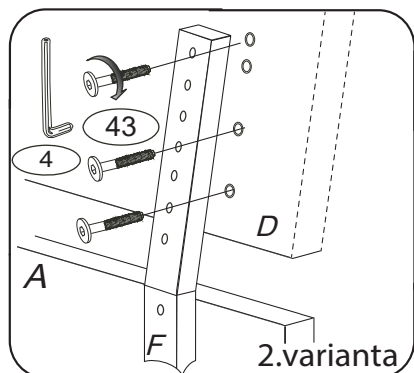
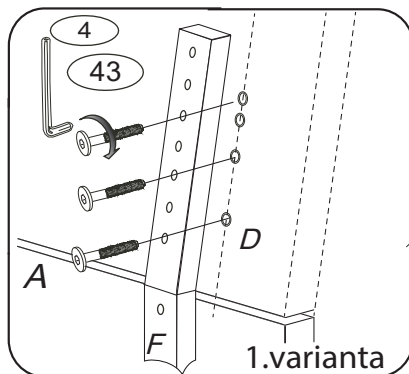

32

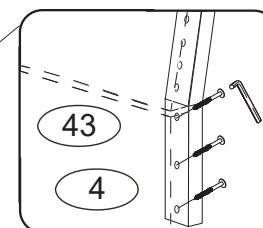

33



34

Na varifixy
položte
lamelové rošty.