

# DOMINO

č. D 105

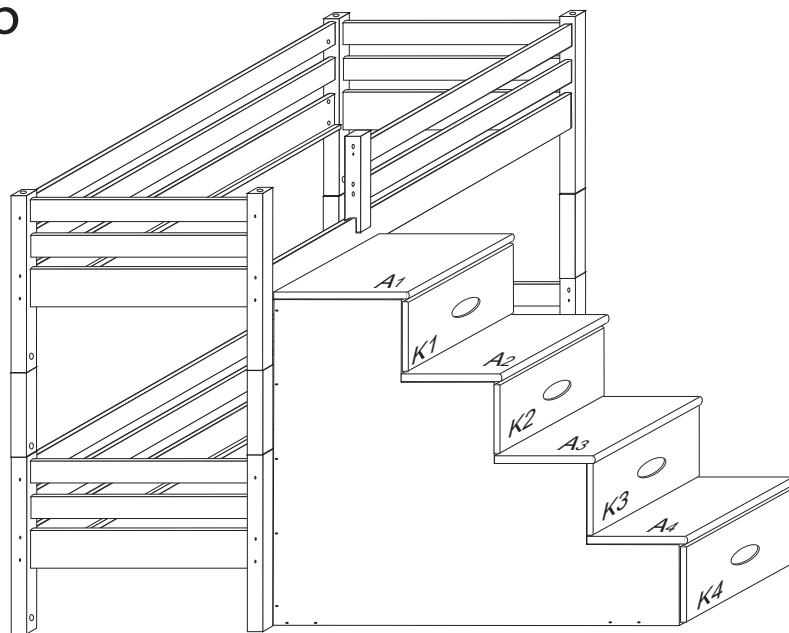

	3 x1 	4 x1 	6 x70 	21 x8 	22 x26 	23 x18 
	č.3	č.4	8x35mm	3x16mm	3,5x16mm	3,5x12mm
27 x4 	61 x20 	60 x2 	68 x18 	70 x50 	71 x16 	
4x30mm	DU 2	15mm	12mm	5x40mm	7x50mm	
80+81 x1 	82+83 x1 	84+85 x1 	87 x16 	96 x4 		
355mm	600mm	650mm				

1/4

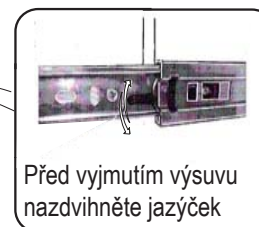
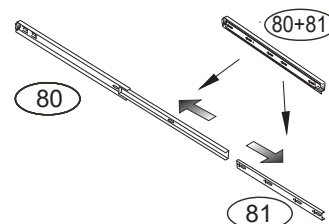

Před vyjmutím výsuvu nazdvihněte jazýček

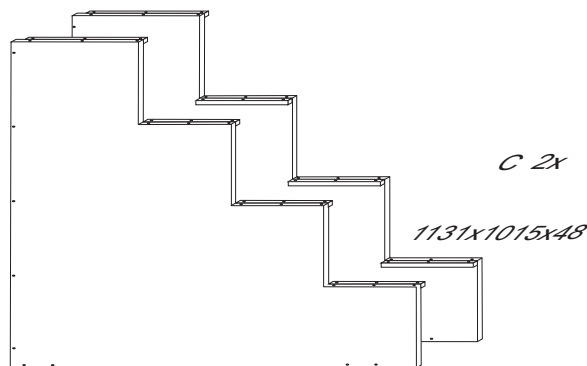

C 2x

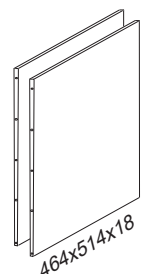

D 2x

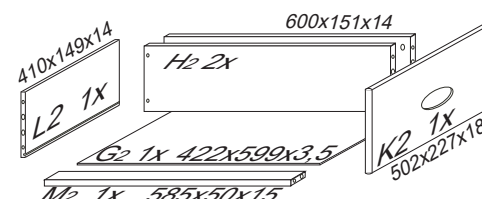
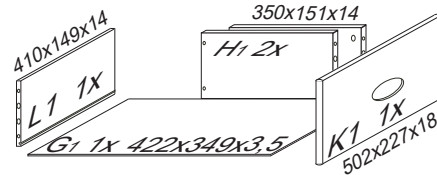
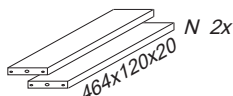
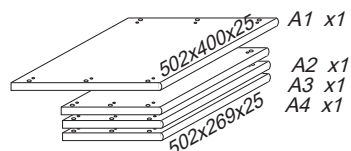
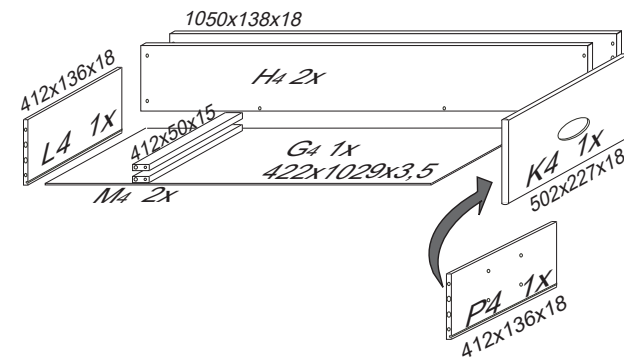
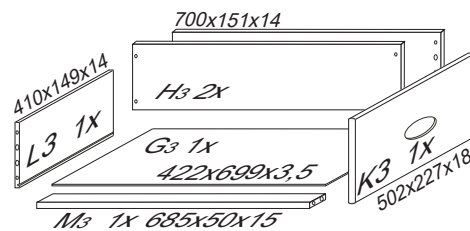

D 105

1

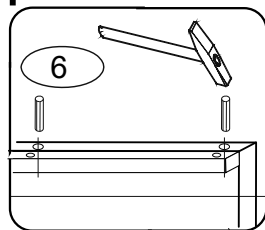

2

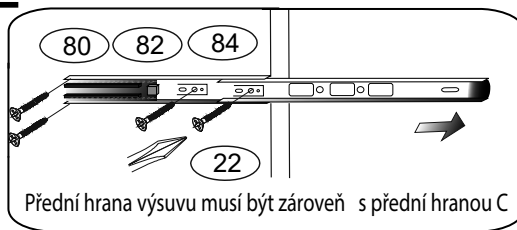

Přední hrana výsuvu musí být zároveň s přední hranou C

7

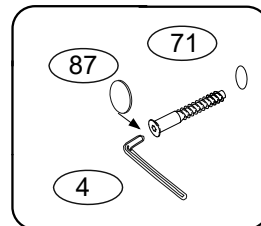

8

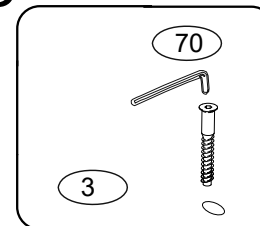

2/4

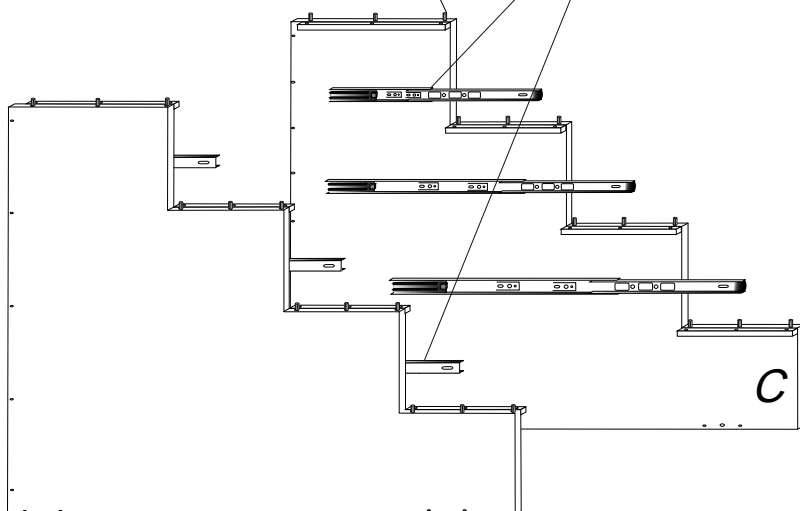

Kolíky vždy narazte nejprve do otvorů ve hranách dílců, je nutné je zarazit se stejným přesahem. V případě, že některý kolík přesahuje, je nutné jej zakrátit. Dílce srážejte kladivem pouze přes dřevěnou podložku.

3

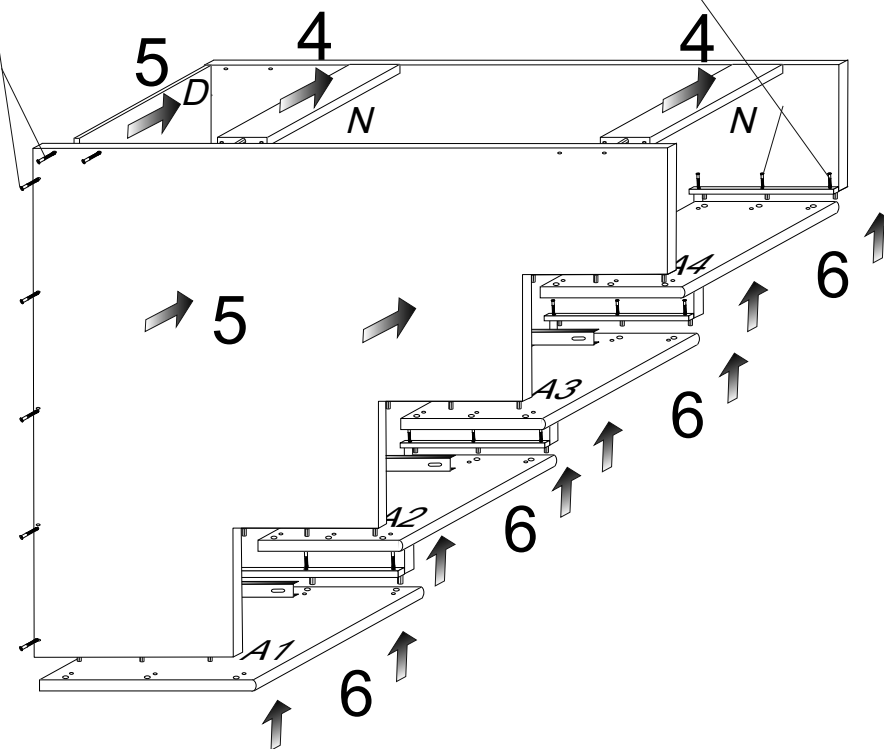
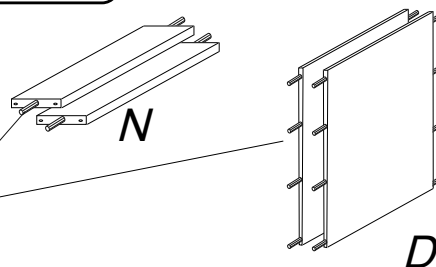
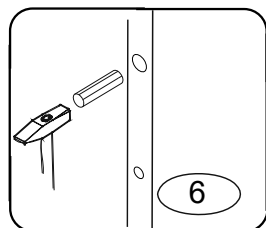

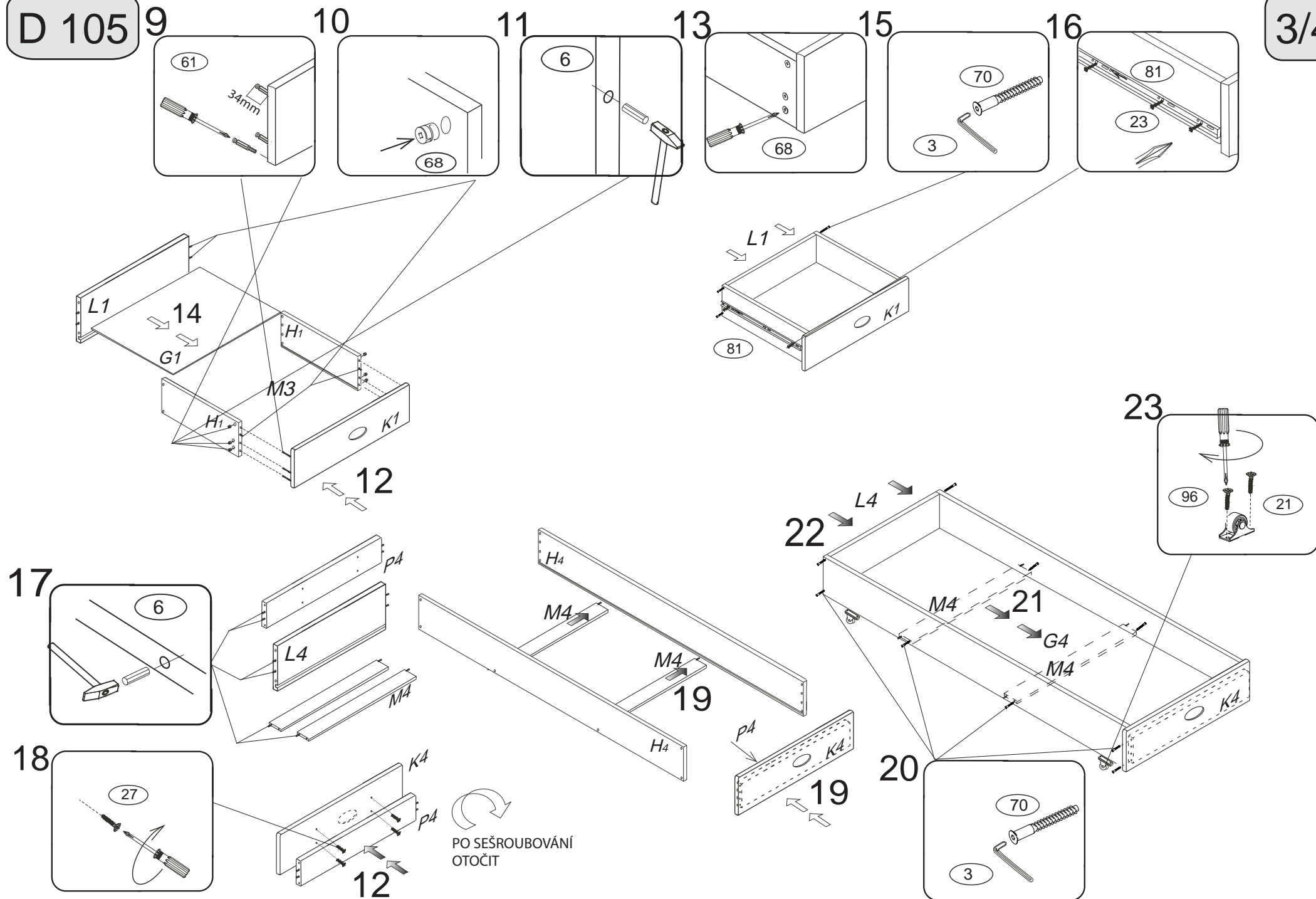

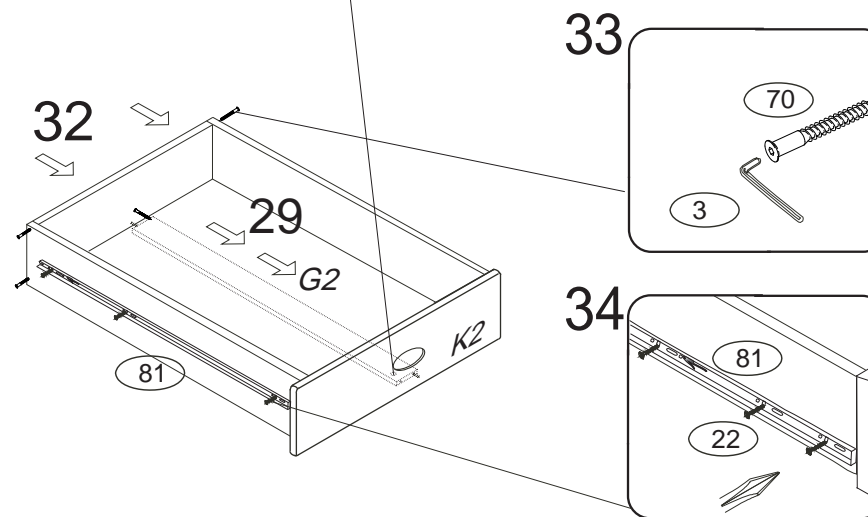
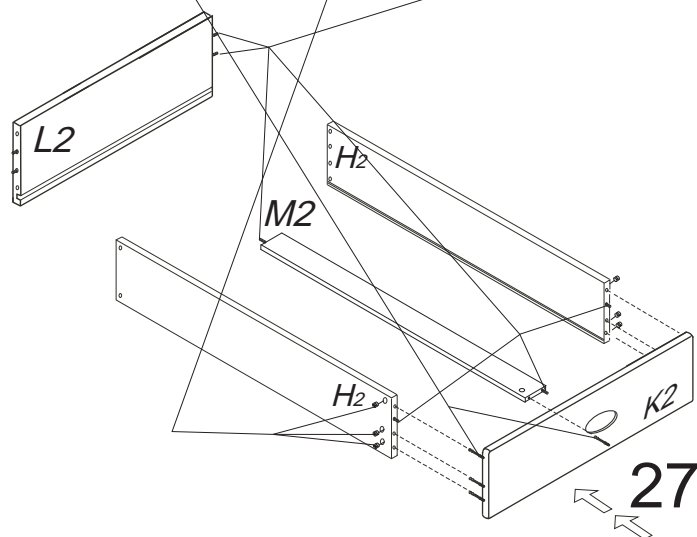
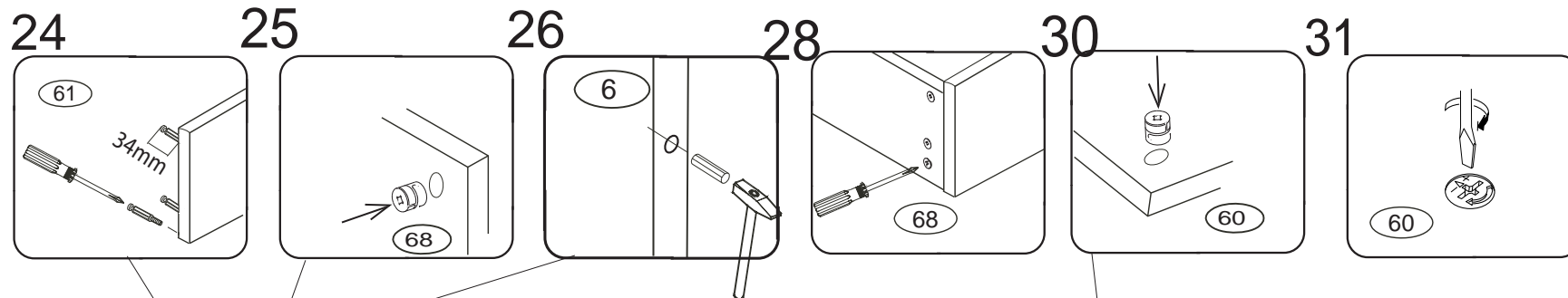

35

Obdobně jako  
zásuvku č.2  
sestavte zásuvku č.3

