

NOČNÍ STOLEK č.F133

500x502x330

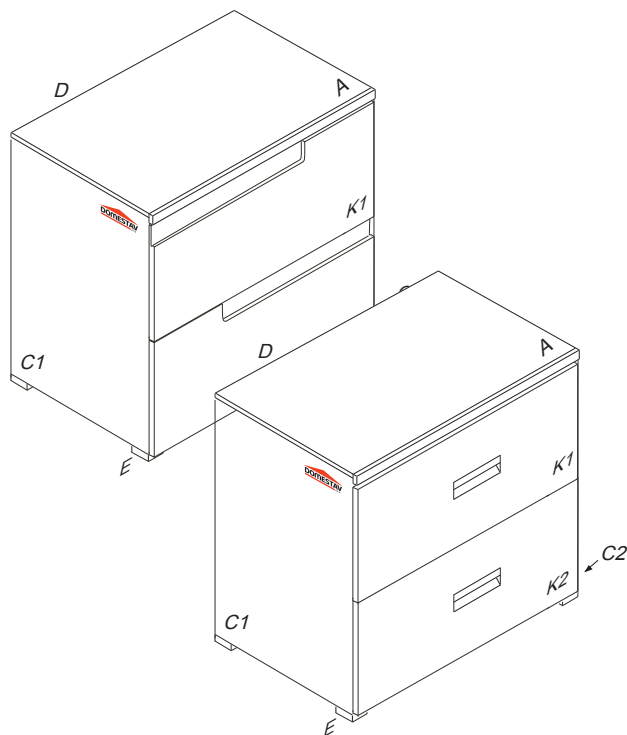

Kolíky vždy narazte nejprve do otvorů ve hranách dílců, je nutné je zarazit se stejným přesahem. V případě, že některý kolík přesahuje, je nutné jej zakrátit. Dílce srážejte kladivem pouze přes dřevěnou podložku.

1/3

	3 x1	4 x1	6 x30	22 x8	43 x8	60 x24
	3mm	4mm	8x35mm	3,5x16mm	EU 6x16mm	15mm
		61 x24	70 x16	80 x2	92 x50	120 x4
		DU 2	5x40mm	300mm	1,4x20mm	filc

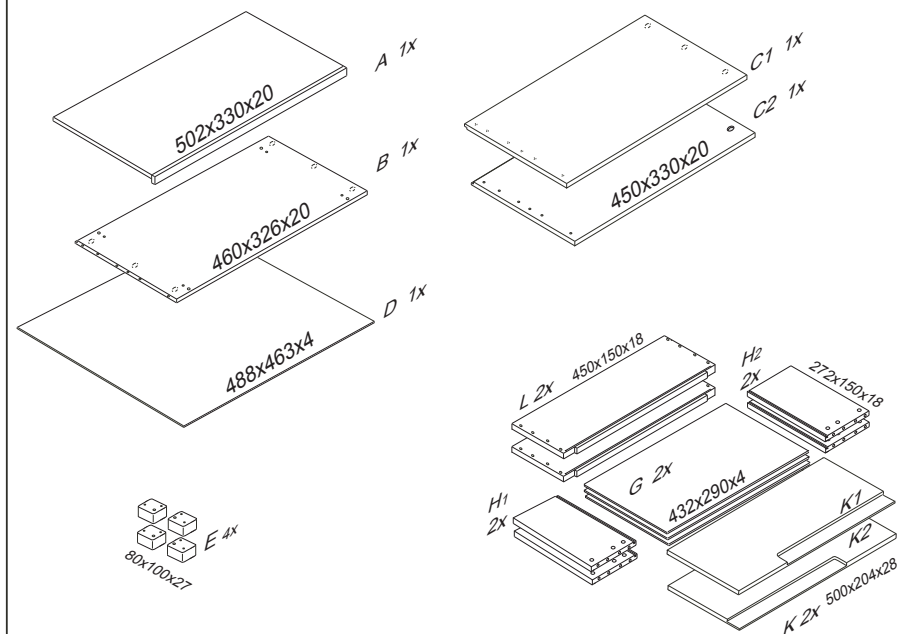

F133

1

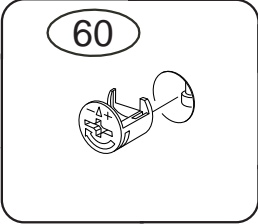

2

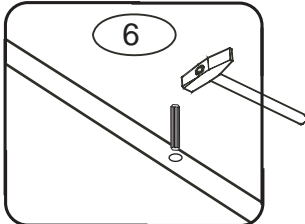

3

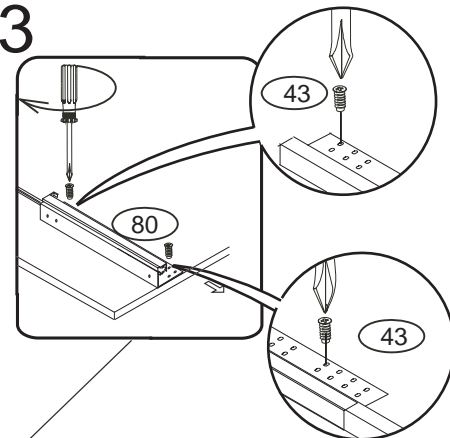

4

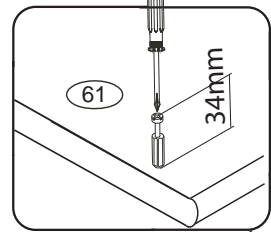

5

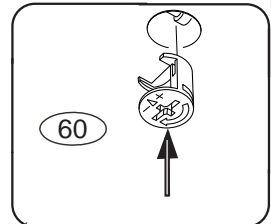

2/3

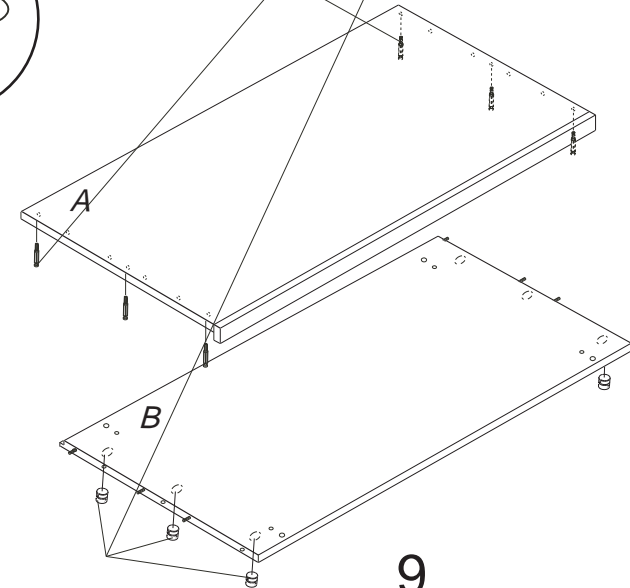
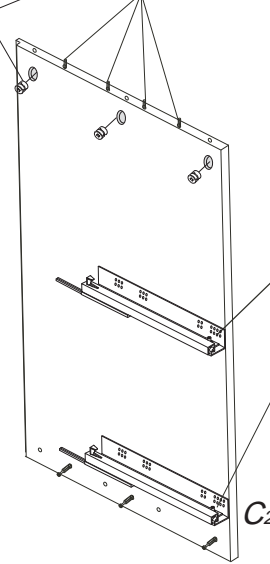
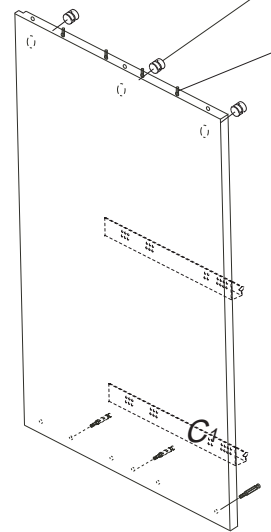

6

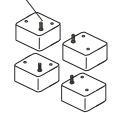
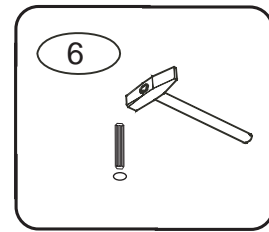

E

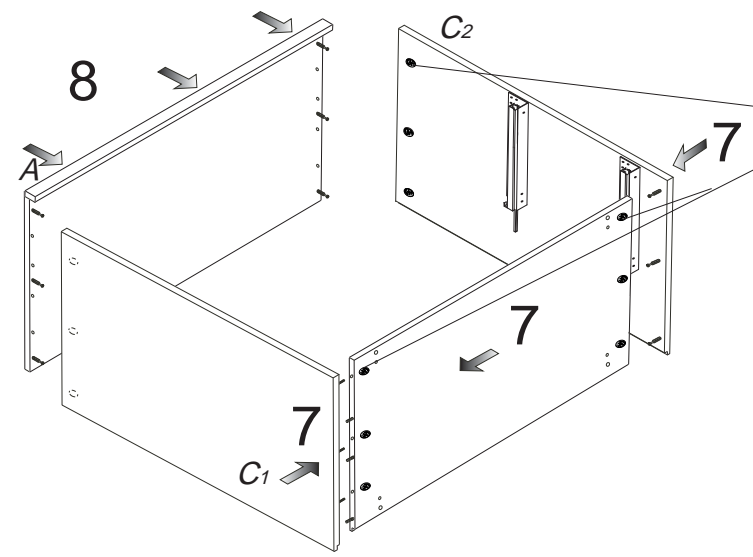

9

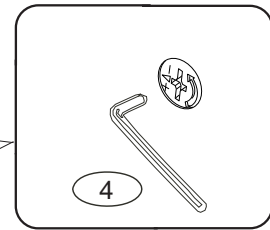

F133

3/3

11

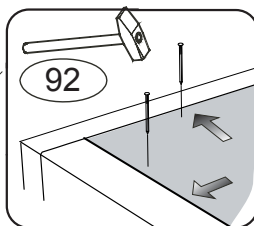

13

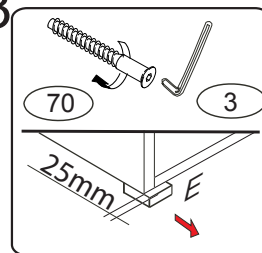

Pro případ nebezpečí, že by stolek přepadával vpřed, je možné nožku přemontovat do předsunuté pozice.



ZÁSUVKU
POLOŽTE DNEM NAHORU

19

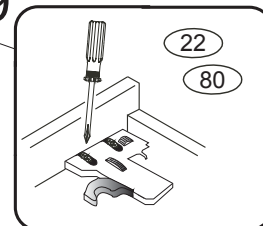
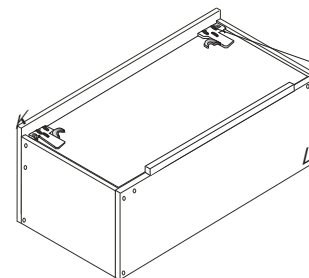

NOČNÍ STOLEK
POLOŽTE ČELEM DOLŮ

14

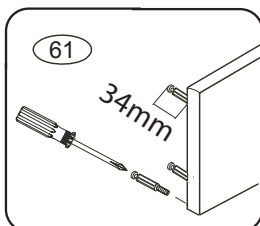

15

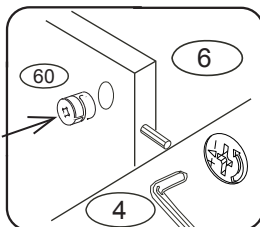

18

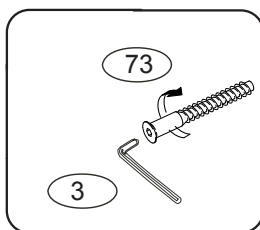

12

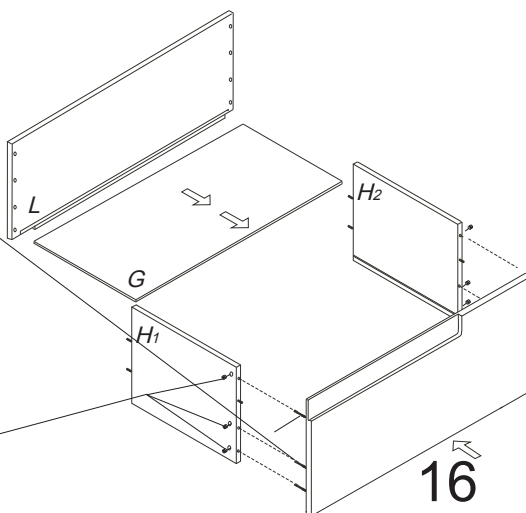

16

17

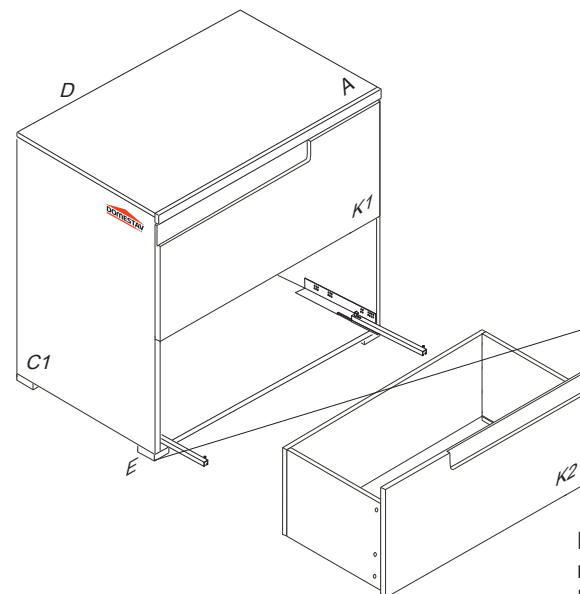
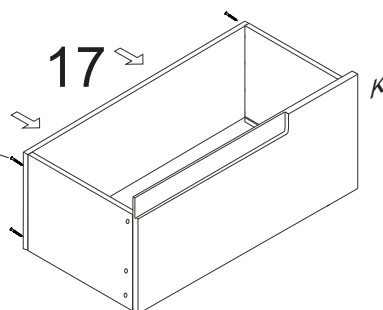

21

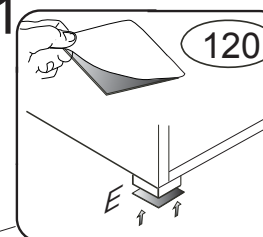

Na vysunuté pojezdy
nasadte zásuvky.
Polohu zásuvek upravte
červeným kolečkem na spoje.

20

