

# DOMINO

č. D 860

č. D 910

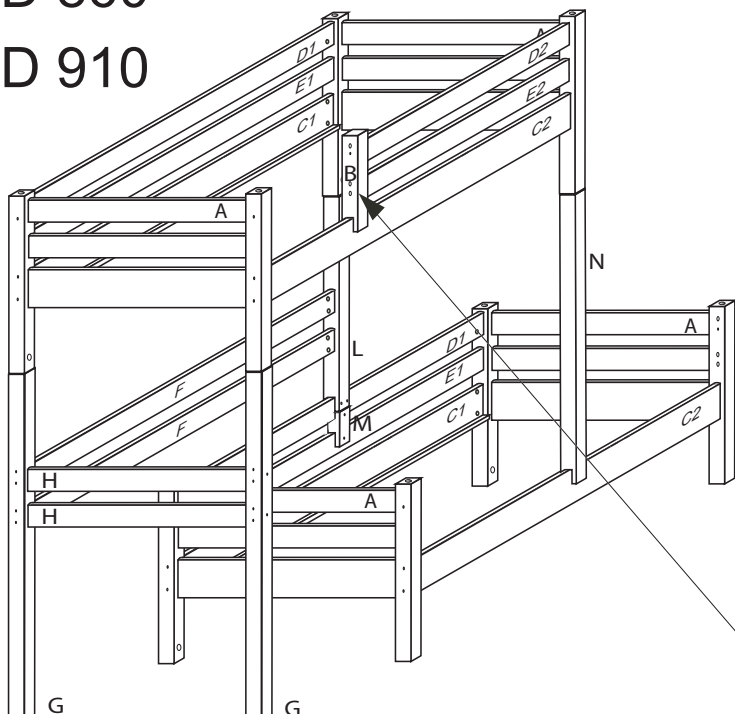

- Uvědomte si nebezpečí pádu malých dětí (do 6 let) z horní postele. **Z hlediska bezpečnosti a stability doporučujeme postel ukotvit ke zdi.**



- **Horní plocha matrace nesmí přesáhnout červenou rysku na stojně zábrany.**

- Maximální výška matrace pro horní lůžko je 210mm.
- Bezpečnostní požadavky dle normy ČSN EN 747-1



Kolíky vždy narazte nejprve do otvorů ve hranách dílců, je nutné je zarazit se stejným přesahem. V případě, že některý kolík přesahuje, je nutné jej zakrátit. Dílce srážejte kladivem pouze přes dřevěnou podložku.

V případě vrzání vtačte do spoje tekuté mýdlo v poměru 1:1 s vodou. Tento jev se u nábytku z masivu vyskytuje běžně.

1/4

|       |        |        |         |         |        |         |
|-------|--------|--------|---------|---------|--------|---------|
|       |        |        |         |         |        |         |
|       | č.4    | č.5    | 10x50mm | 6x100mm |        |         |
|       |        |        |         |         |        |         |
|       | 4x30mm | 4x35mm | 4x40mm  | 5x30mm  | 5x60mm |         |
|       |        |        |         |         |        |         |
| 47 x5 | 87 x8  | 88 x18 | 89 x6   | 90 x4   | 109 x2 | 110 x2  |
|       | 5mm    | 7mm    | 10mm    | 25mm    |        | 10x50mm |

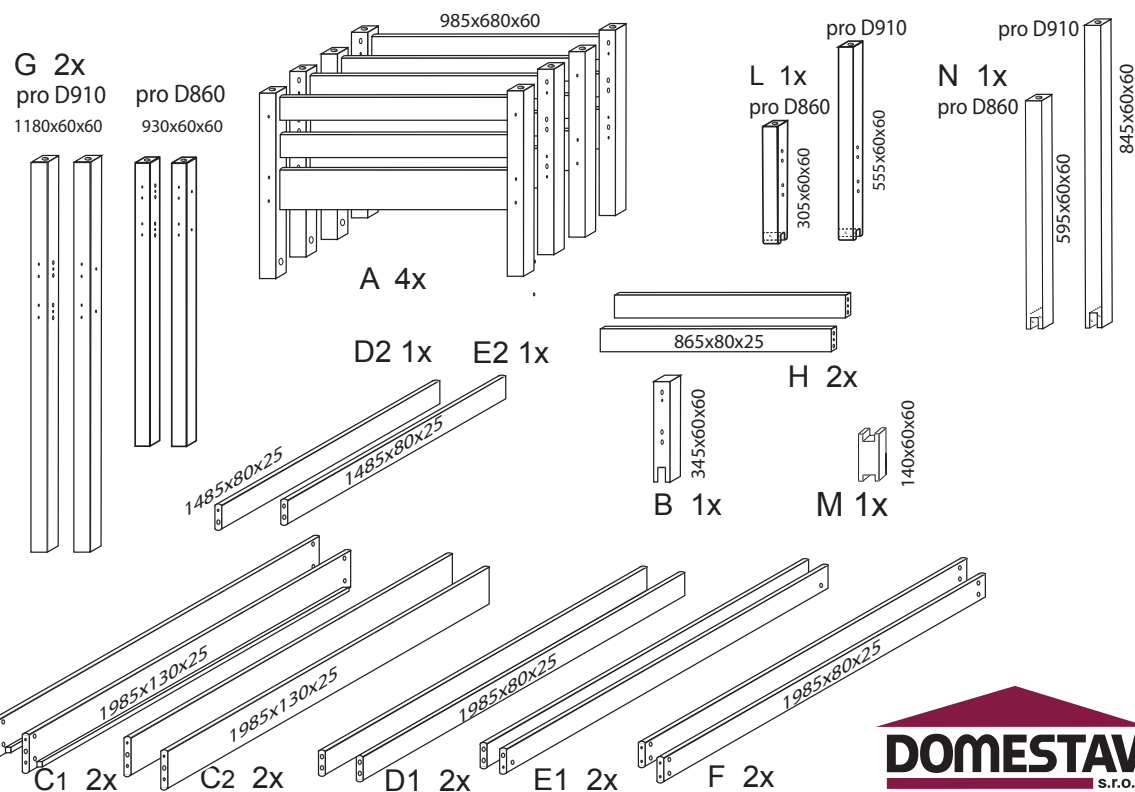

D910  
D860

2/4

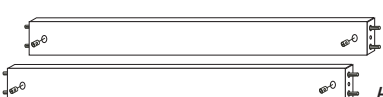
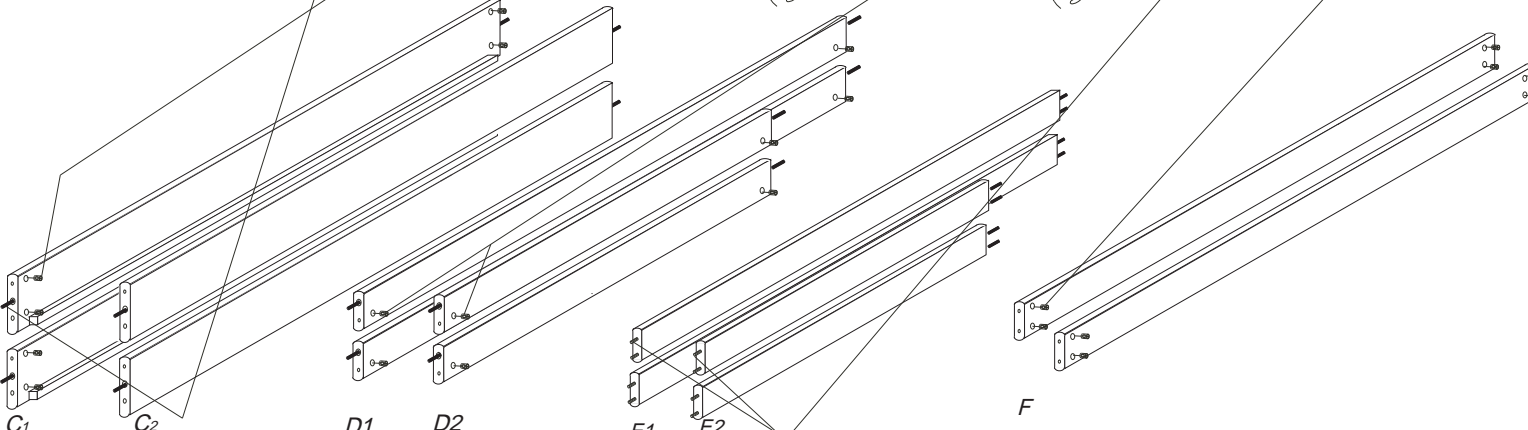
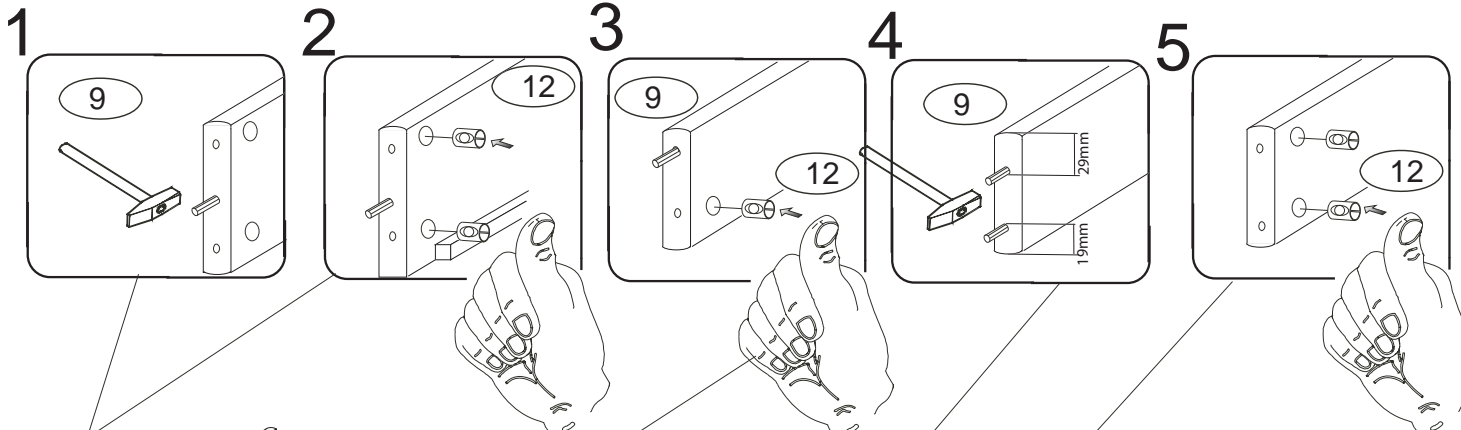

H

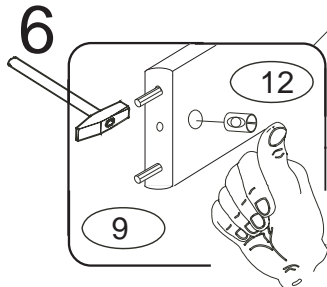

7 pro snazší zašroubování  
namažte šroub mýdlem  
nebo olejem

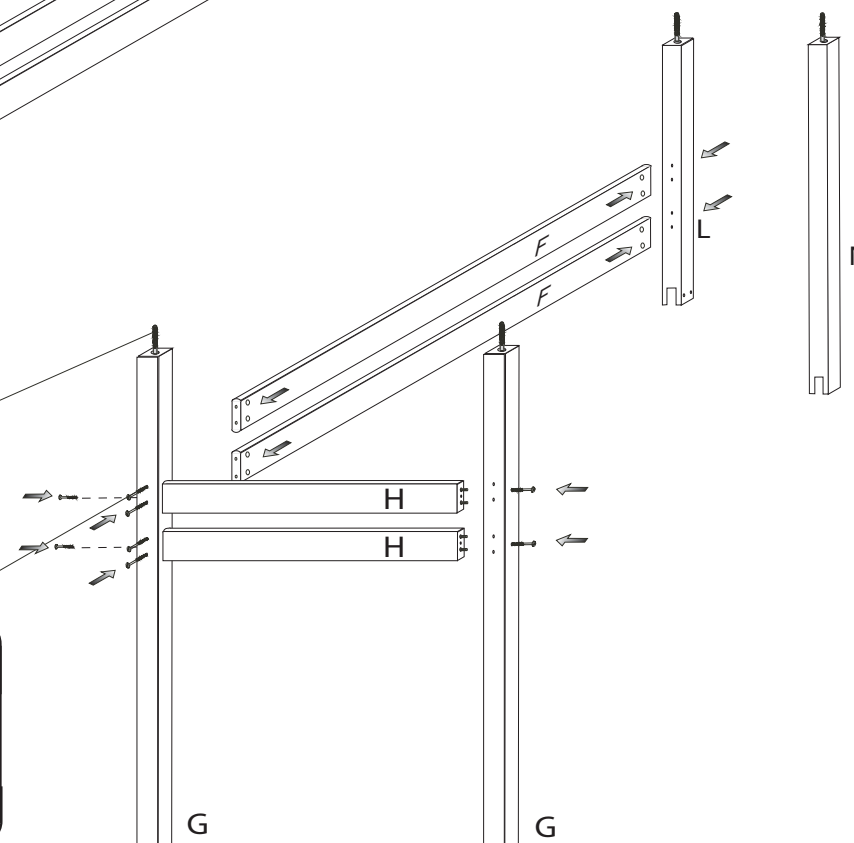
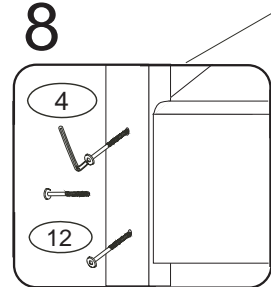
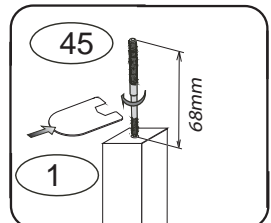

D910  
D860

3/4

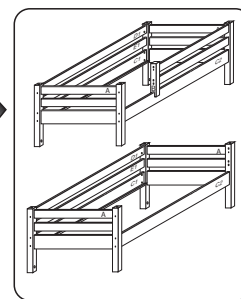
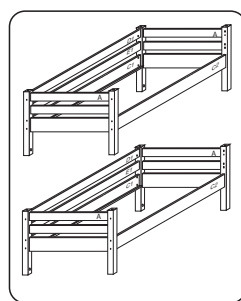
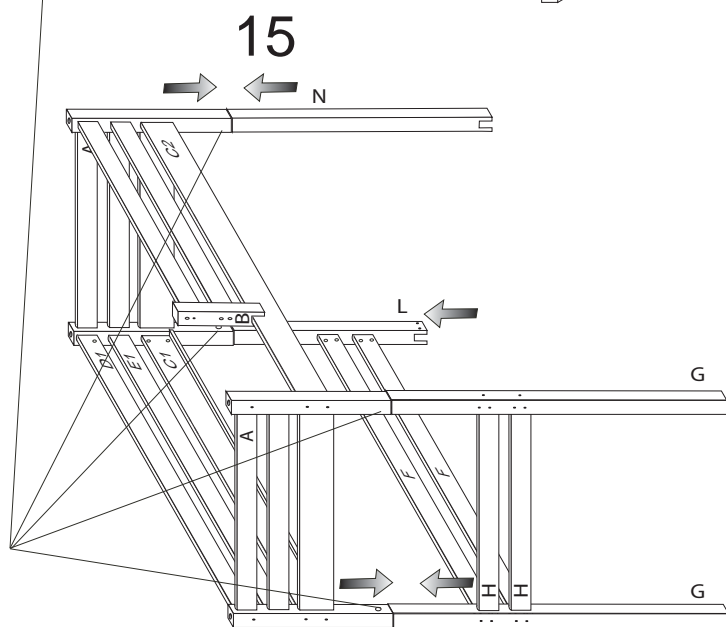
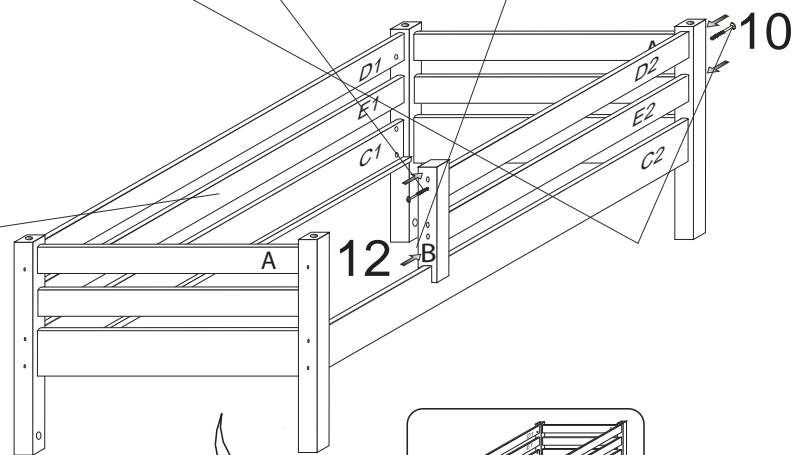
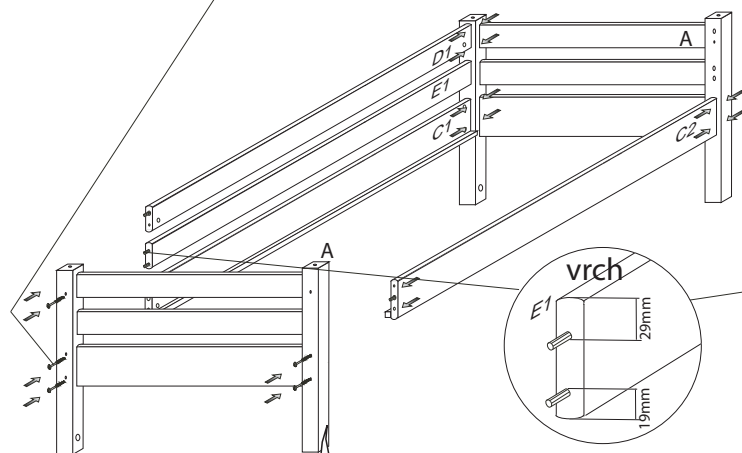
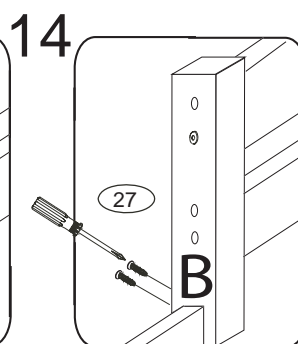
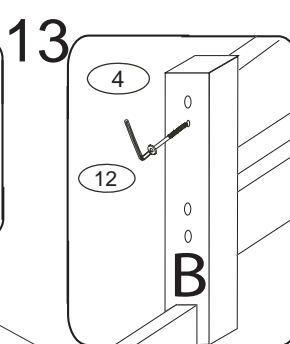
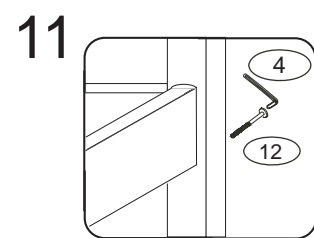
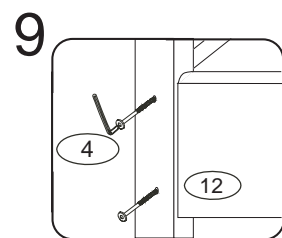
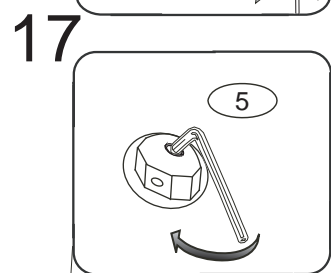
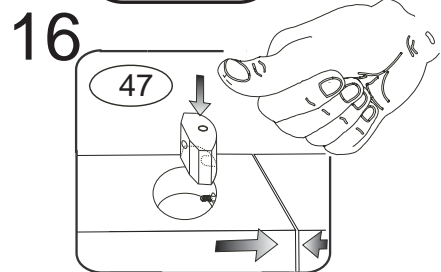

D910  
D860

4/4

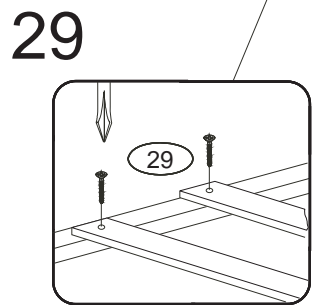
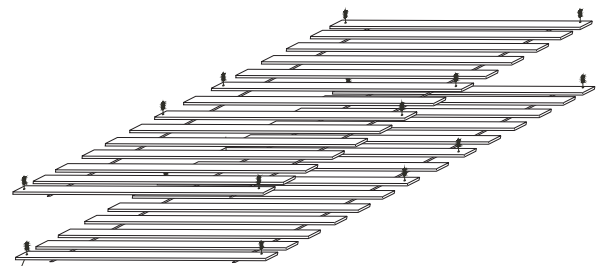
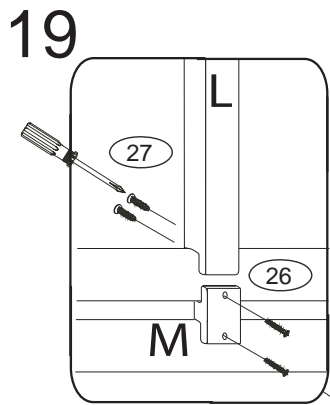
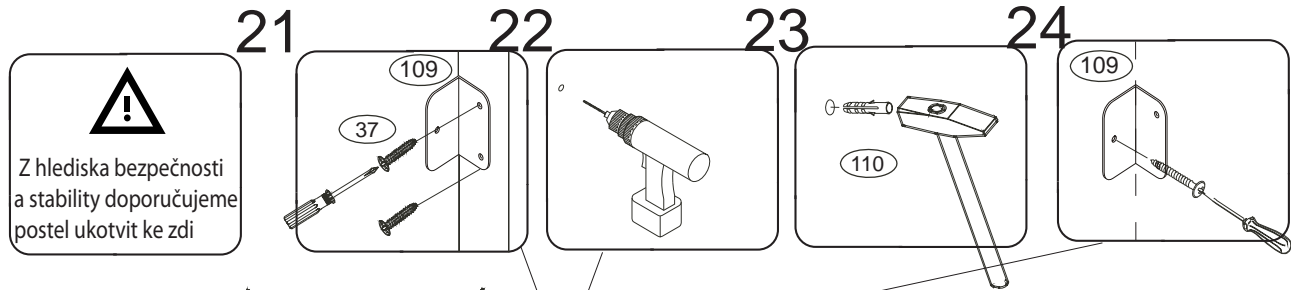

20

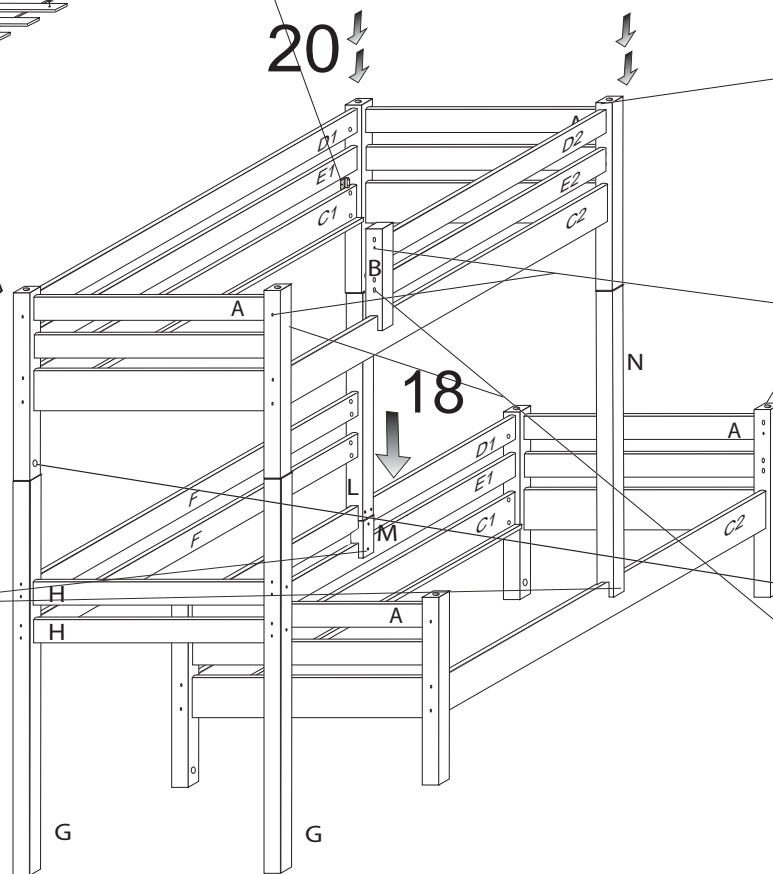

25

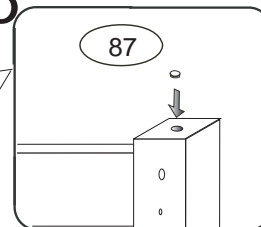

26

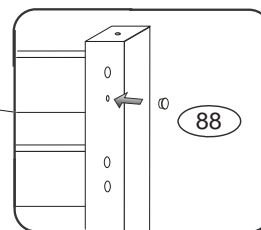

27

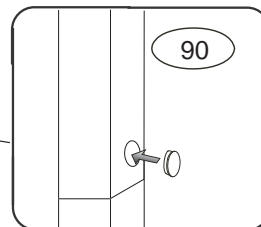

28

